

---

# Steam Mop

---

## Information for use

Thank you for purchasing this Steam Mop from DMD Collective.

The DMD Steam Mop harnesses the power of steam to deliver a deep, hygienic clean. By converting water into heated steam, it effortlessly lifts dirt, grime, and bacteria from hard floor surfaces, tiles, grout, and much more.

Please read through all the information in this document and keep it for future reference.



# Health and Safety Guidelines

- Always unplug the unit when not in use, before cleaning, or when adding or removing parts. Please read the instructions carefully before using any appliance.
- Always ensure that the voltage on the rating label corresponds to the mains voltage in your home.
- Incorrect operation and improper use can damage the appliance and cause injury to the user.
- The appliance is intended for household use only. Commercial use invalidates the warranty, and the supplier cannot be held responsible for injury or damage caused when using the appliance for any other purpose than that intended.
- Check the power cord and plug regularly for any damage. To prevent an electrical hazard, the manufacturer will need to replace the cord or plug if it is damaged.
- Do not use the appliance if it has been dropped or damaged in any way. If the unit is damaged, take it in for examination and/or repair by an authorised service agent.
- To reduce the risk of electric shock, do not immerse or expose the assembly, plug, or power cord to water or any other liquid.
- Never immerse the unit in water or any other liquid for cleaning purposes. Do not reach for an appliance that has fallen into the water. Unplug immediately.
- Remove the plug from the socket by gripping the plug. Do not pull on the cord to disconnect the appliance from the mains.
- Injury, fire, or electric shock could result from the use of accessory attachments that the manufacturer has not approved or supplied.
- A short cord is provided to reduce the hazards resulting from becoming entangled in or tripping over a longer cord.
- Do not let the cord hang over the edge of a table or counter.
- Ensure that the cord is not in a position where it can be pulled inadvertently.
- Do not allow the cord to touch hot surfaces, and do not place it on or near a hot gas or electric burner or a heated oven. Do not place the unit on a hot surface.
- This appliance is not suitable for outdoor use. Do not use this appliance for anything other than its intended purpose.
- Do NOT carry the unit by the power cord.
- Do not leave this appliance unattended during use. An appliance should never be left unattended when plugged in.
- The manufacturer does not accept responsibility for any damage or injury caused by improper or incorrect use or for repairs carried out by unauthorised personnel.
- In the event of technical problems, switch off the appliance and do not attempt to repair it yourself. Return the appliance to an authorised service facility for examination, adjustment, or repair.
- Always insist on the use of original spare parts. Failure to comply with the above-mentioned precautions and instructions will affect the safe operation of this machine.
- We do not recommend using extension cords with this product.
- Never direct steam towards people, animals plants or electrical equipment.
- Do not use on leather, wax polished furniture or floors, unsealed hardwood or parquet floors, synthetic fabrics, velvet or other delicate steam-sensitive materials.
- Do not use without the floor cloth in place or water in the water tank.
- Never put hot water or any other liquids such as aromatic, alcohol based or detergent products into the water tank.
- Do not block the steam openings of the product.
- Do not open the filling aperture during use.

- On surfaces that have been treated with wax, the wax may be removed by the heat and steam action. Do not use on unsealed wood floors or let unit stand on any wood floor. When using on vinyl, linoleum or any other heat sensitive floors, use extra caution. Too much heat can melt down glue in the flooring. It is therefore recommended that a sample cleaning be carried out on an isolated area of the floor.
- Don't use the steam mop without microfiber cloth pad on the mop head.
- The carpet glider is only for use on carpet. Not for use on other floor surfaces.
- Do not use for space heating.
- Care should be taken when using the appliance due to emission of steam & to avoid scalding.
- Do not use the steam mop in enclosed spaces that are filled with flammable, explosive or toxic vapor such as paint thinner or oil-based paint.

# What's included:

- Steam Mop Unit
- Microfibre Cloth
- Carpet Glider
- Steamer Cloth
- Steam Cloth Shelf
- Funnel & Measuring Cup
- Long Brush
- Big Round Brush
- Small Round Brush
- Scraper Tool
- Accessory Adaptor
- Squeegee Attachment
- Angled Nozzle



# Key Features

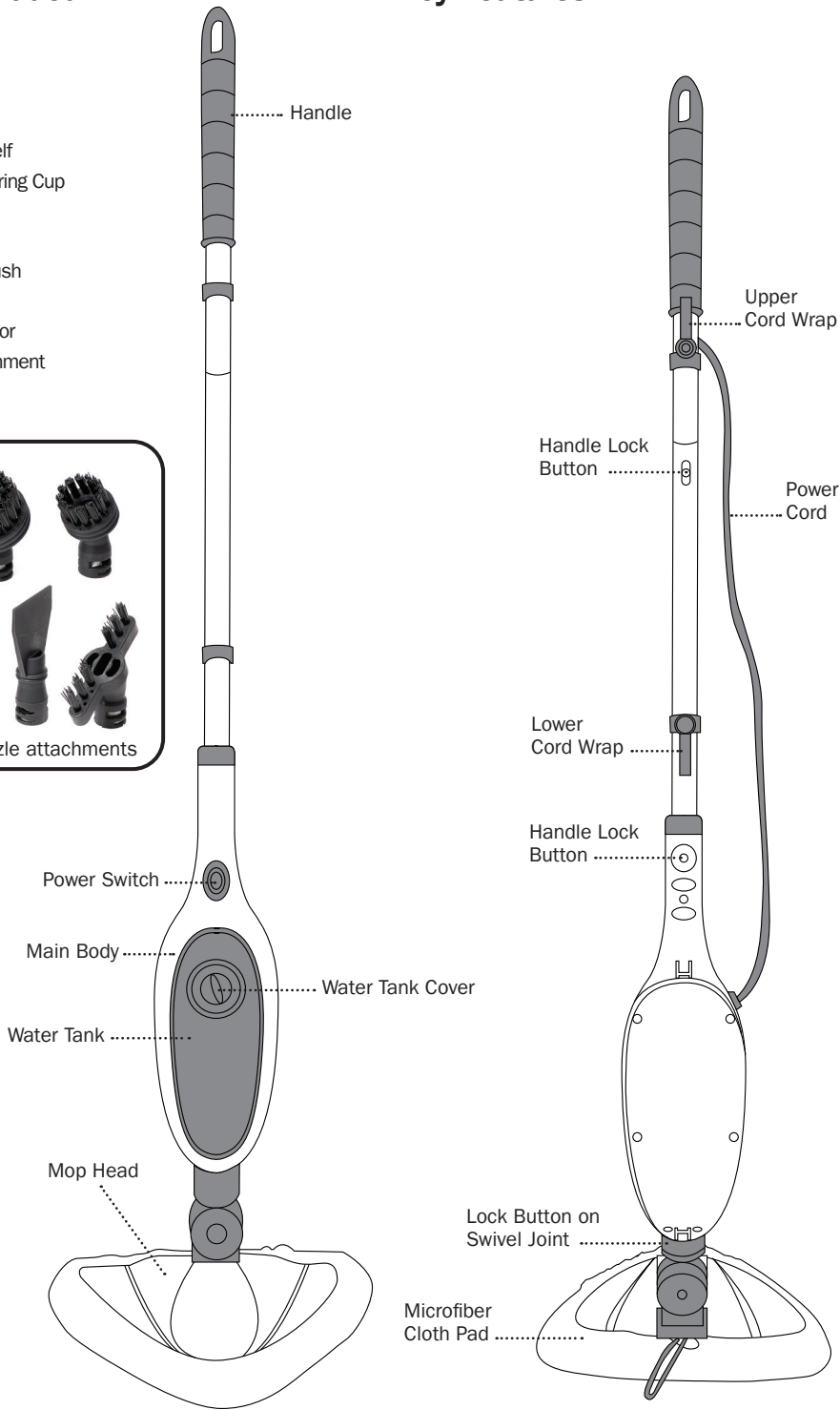

# Instructions for Use

1. Attaching the mop head to the body: Press the lock button (on the swivel joint) and insert it into the hole on the main body until it locks in place (Fig. 1).

Fig. 1

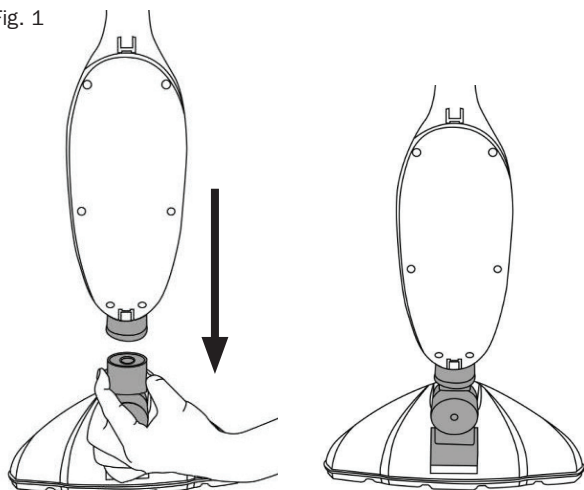

2. Assemble the handle and insert it into the body until it clicks into place with the lock button (Fig. 2).

Fig. 2

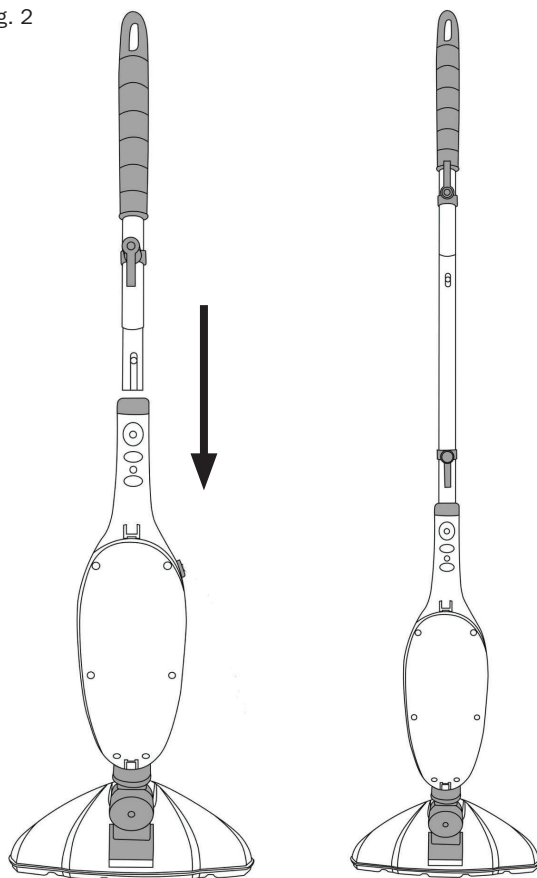

3. Place the microfiber cloth pad onto the mop head.
4. Fasten the microfiber cloth pad by pulling the cord while pressing on the toggle (Fig. 3).
5. When using the steam mop on carpets, place the mop head (with microfiber cloth) over the carpet glider (Fig. 4).

**PLEASE NOTE:** Do not operate without the microfiber cloth in place.

6. Position the mop at a 45° angle, remove the water tank cover, and fill the tank with water using the provided measuring cup (Fig. 5).
7. Once fully assembled and filled with water, plug the item into the mains supply. Change the power switch (O/1) to the ON (1) position. After approximately 20 seconds, the mop will start emitting steam. To stop the steam, turn the power switch (O/1) to the OFF (0) position.

**PLEASE NOTE:** Before the steam starts, it's usual for water to come out of the nozzle.

8. Before using the steam mop, we recommend sweeping or vacuuming the floor. After that, slowly mop the surface that requires cleaning.

9. **CAUTION:** To sanitise an area of the floor, leave the steam mop over the area for a minimum of 8 seconds, but no longer than 15 seconds. Leaving the steam mop in a stationary position for longer than recommended may cause the buildup of a pale residue. This residue can be removed by using a decalcifying product. Alternatively, you can use a few drops of vinegar (see troubleshooting guide).

10. After cleaning, unplug the power cord from the outlet and empty the water tank. Wait for the cloth pad to cool down before carefully removing it from the head. Next, wind the power cord around the cord wrap and store it upright in a dry area or hang it by the storage hook.

**CAUTION:** The cloth pad may be extremely hot.

Fig. 3

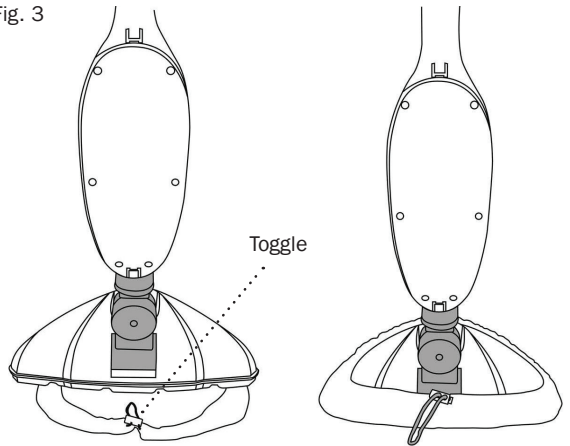

Fig. 4

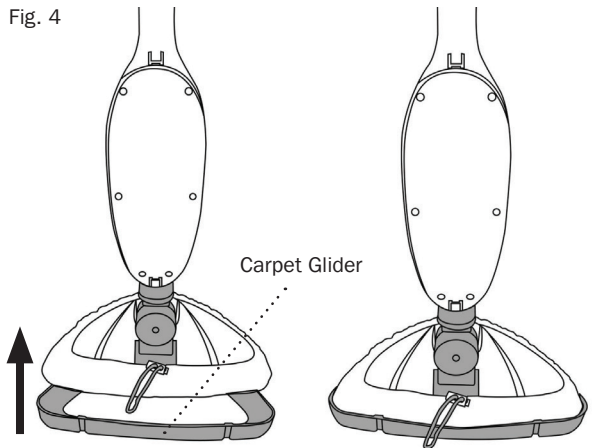
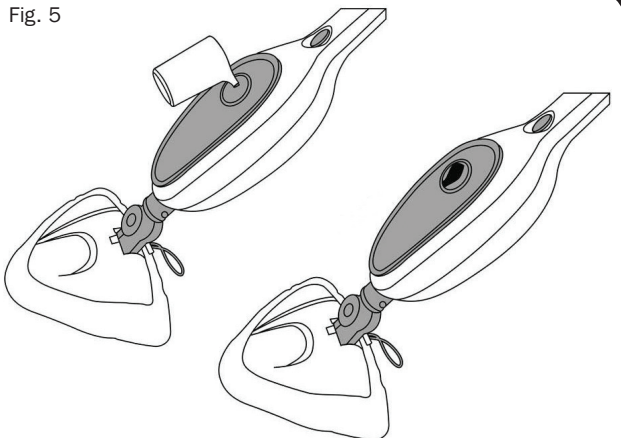

Fig. 5



# Cleaning & Maintenance

## ENSURE THAT THE UNIT IS DISCONNECTED FROM THE POWER OUTLET WHEN PERFORMING CLEANING

- Drain any remaining water in the tank and clean it after every use.

### How to decalcify the water tank interior:

1. To clean calcium deposits that build up inside the water tank, add one or two tablespoons of white vinegar to the full tank, close the water tank cap, and shake the contents. Do not turn the steamer on.
2. Let the unit sit for a few hours. Then, empty the water tank, refill it with clean water, and continue to empty it until it rinses clear.

### How to remove limescale:

If your steam mop begins to produce steam more slowly than usual or stops, you may need to remove limescale. Limescale can develop over time on the metal parts and greatly affect mop performance.

It is necessary to remove limescale on a regular basis every 25–50 times you use a full tank of water or at least once a month, especially in areas with hard water. For optimal results, use distilled water in areas that have hard water.

1. Prepare a solution of 1/3 white vinegar and 2/3 tap water and add to the water tank.
2. Secure and position the unit to direct the steam away from the floor or nearby objects and surfaces. Plug the unit in, turn the unit ON by pressing the Power Switch (O/I) and allow the unit to produce steam until the vinegar/water solution is used up.
3. Continue the above process as often as required until you reach a normal steam flow rate.
4. Fill the water tank with fresh water and rinse out.
5. Fill the water tank with fresh water and release steam through the system until it is empty.
6. After each limescale removal, conduct a test cleaning in a suitable isolated area to confirm that there is no debris in the system. Do not leave the steamer unattended during the limescale removal or while in use.

# Troubleshooting

Problem	Causes	Solution
The unit does not power on.	The unit is not plugged in or powered on.	Make sure the unit is plugged into a proper outlet and the switch is ON (I).
Reduced steam or no steam.	<ul style="list-style-type: none"><li>• Water tank empty</li><li>• Blocked steam nozzle</li><li>• Limescale deposit</li></ul>	<ul style="list-style-type: none"><li>• Fill water tank</li><li>• Remove mop head &amp; clean the nozzle.</li><li>• Follow limescale cleaning procedure in this manual.</li></ul>
Pale residue left on the floor.	Due to the steam mop being left in a stationary position too long.	Use household white vinegar or a decalcifying product to remove this residue. Alternatively, you can reheat the area for one minute to remove the residue. Do not overheat the area.
The cleaning cloth is wet.	The cloth gets saturated with water.	Remove the wet cloth and replace it with a new one, or let it cool before wringing it out and reattaching

# Technical Support

If you require any technical support for your product within the warranty period, please contact us on **support@dmdcollective.co.uk** and provide the product name and supplier code (see Technical Specifications) along with the technical query and proof of purchase.

## WEEE



The WEEE symbol  on this product means that this unit should be ethically dismantled or recycled to minimise environmental impact. Please check with your local authority for more information.

## IMPORTANT: ADDITIONAL SAFETY INFORMATION

**Warning:** This product is not intended for use by children or individuals with reduced physical, sensory, or mental capabilities unless supervised by a responsible adult. Small parts may present a choking hazard. Always keep out of reach of children.

## Technical Specifications

Product Name:	DMD Steam Mop
Supplier Code:	DMD141
Power:	1300W
Voltage:	220~240V
Frequency:	50/60Hz
Water Tank Capacity:	280ml
Pressure:	0.8 bar
Steam temperature:	105°C
Size:	115 x 30 x 23cm
Material:	Plastic, aluminium, microfibre



<b>Ace Supply Co Ltd.,</b> Suite GA, Marsland House, Marsland Road, Sale M33 3AQ	<b>For Product Support:</b> <b>E:</b> support@dmd collective.co.uk <b>T:</b> +44 (0)161 543 6400	<b>EU Regd. Address:</b> Ace Supply Co (Europe) Ltd., Dublin 2, D02 A098, ROI
--	--	---