

Electric Window Cleaner

Information for use

Contents:

- Electric Window Cleaner
- 350ml Spray Bottle
- 2x Microfibre Cloths
- Charging Adapter



Thank you for purchasing this Electric Window Cleaner from DMD Collective. The window cleaner is exclusively designed for wet-cleaning windows, tiles or mirrors and other smooth surfaces,

Please read through all the information in this document and keep it for future reference.

Health and Safety Guidelines

- Always unplug the unit when not in use, before cleaning, or when adding or removing parts. Please read the instructions carefully before using any appliance.
- Always ensure that the voltage on the rating label corresponds to the mains voltage in your home.
- Incorrect operation and improper use can damage the appliance and cause injury to the user.
- The appliance is intended for household use only. Commercial use invalidates the warranty, and the supplier cannot be held responsible for injury or damage caused when using the appliance for any other purpose than that intended.
- Do not let children use this appliance unsupervised.
- Check the power cord and plug regularly for any damage. To prevent an electrical hazard, the manufacturer will need to replace the cord or plug if it is damaged.
- Do not use the appliance if it has been dropped or damaged in any way. If the unit is damaged, take it in for examination and/or repair by an authorized service agent.
- To reduce the risk of electric shock, do not immerse or expose the motor assembly, plug, or power cord to water or any other liquid.
- Never immerse the unit in water or any other liquid for cleaning purposes. Do not reach for an appliance that has fallen into the water. Unplug immediately.
- Remove the plug from the socket by gripping the plug. Do not pull on the cord to disconnect the appliance from the mains.
- Injury, fire, or electric shock could result from the use of accessory attachments that the manufacturer has not approved or supplied.
- A short cord is provided to reduce the hazards resulting from becoming entangled in or tripping over a longer cord.
- Do not let the cord hang over the edge of a table or counter.
- Ensure that the cord is not in a position where it can be pulled inadvertently.
- Do not allow the cord to touch hot surfaces, and do not place it on or near a hot gas or electric burner or in a heated oven. Do not place the unit on a hot surface.
- Do NOT carry the unit by the power cord.
- Do not leave this appliance unattended during use. An appliance should never be left unattended when plugged in.
- The manufacturer does not accept responsibility for any damage or injury caused by improper or incorrect use or for repairs carried out by unauthorised personnel.
- In the event of technical problems, switch off the appliance and do not attempt to repair it yourself. Return the appliance to an authorised service facility for examination, adjustment, or repair.
- Always insist on the use of original spare parts. Failure to comply with the above-mentioned precautions and instructions will affect the safe operation of this machine.
- We do not recommend using extension cords with this product.
- Do not use the window cleaner to vacuum any burning or glowing items, such as cigarettes, matches or ash or any flammable or combustible liquids (e.g. petrol).
- Do not use the window cleaner, if battery fluid is leaking out of the window cleaner. In this case, contact the manufacturer.

- The batteries installed in the window cleaner shall not be exposed to excessive heat such as sunshine, fire or the like.
- This appliance contains batteries that are non-replaceable.
- Only use the window cleaner on smooth, wet-pre-cleaned surfaces. The squeegee lip will otherwise wear and become physically damaged.
- Never put the window cleaner into the dishwasher.
- Only use commercially available glass cleaner for the window cleaner. Do not use any methylated spirit or foaming detergent.
- Never use the window cleaner without the water storage tank.
- Do not cover up ventilation slots on the bottom of the unit while using.
- Do not use the window cleaner if the plastic components of the window cleaner have cracks or flaws or is leaking.
- If the device is not used for an extended period, it is recommended that you fully charge the device every 3 months to preserve the rechargeable battery life. Do not leave the rechargeable battery unused for extended periods of time.

Assemble The Window Cleaner

1. Press the lock and unlock button of the squeegee attachment (Fig 1).
2. Attach the squeegee attachment onto the body of the cleaner.
3. Release the lock and unlock button.

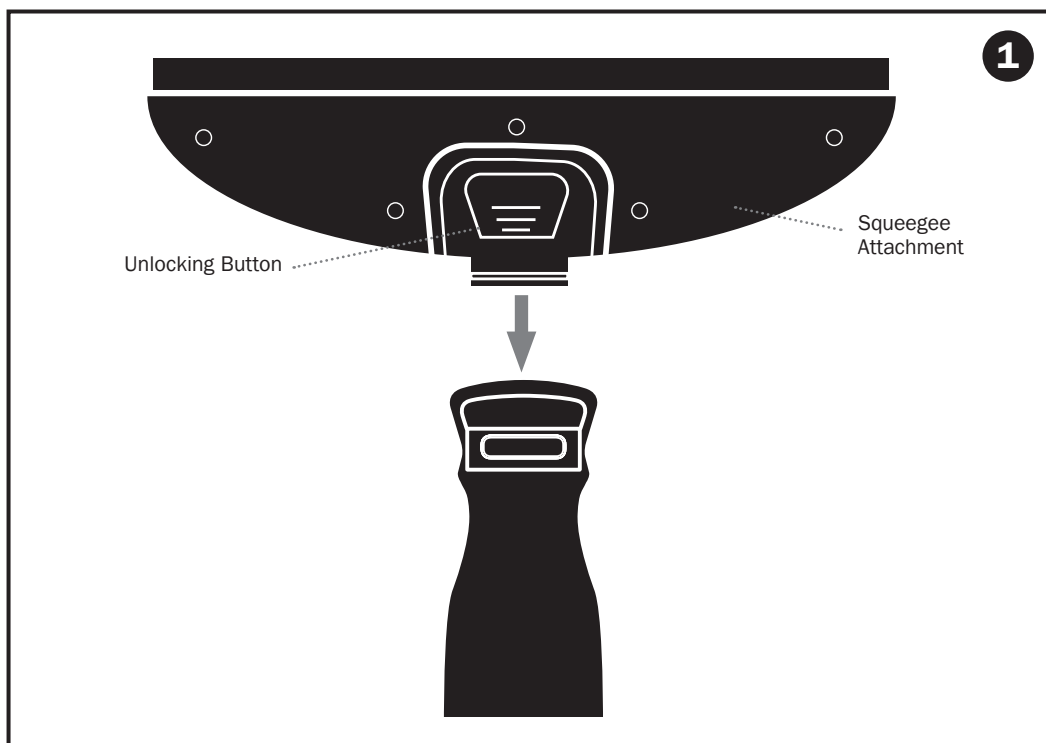

Assemble The Spray Bottle

1. Prior to using the window cleaner, you should wet-clean the relevant surfaces. For this, use the spray bottle and the mountable wiping attachment.
2. Attach the mounting ring to the thread of the water bottle. The recesses in the mounting ring must point towards the sides. You should hear and feel the mounting ring engage (Fig. 2).
3. Fill the bottle with water & appropriate detergent for cleaning windows.
4. Insert the hose of the spray head into the bottle and screw the threaded ring onto the bottle.
5. Set the nozzle of the spray head to STREAM or SPRAY (fine mist).
6. Place the wiping attachment over the spray head and click into place (Fig. 3).

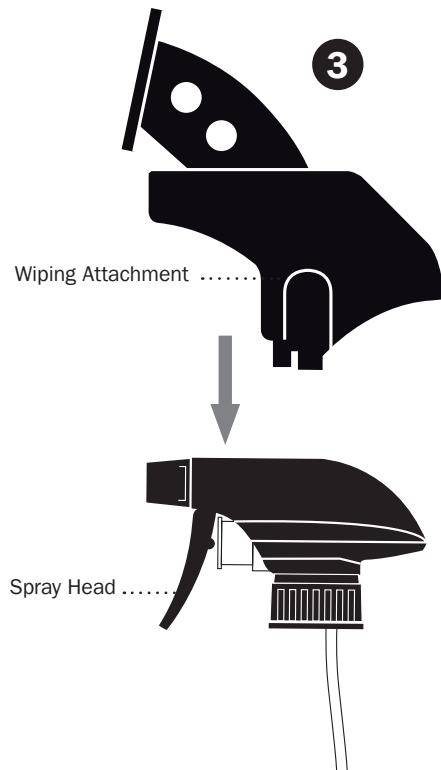
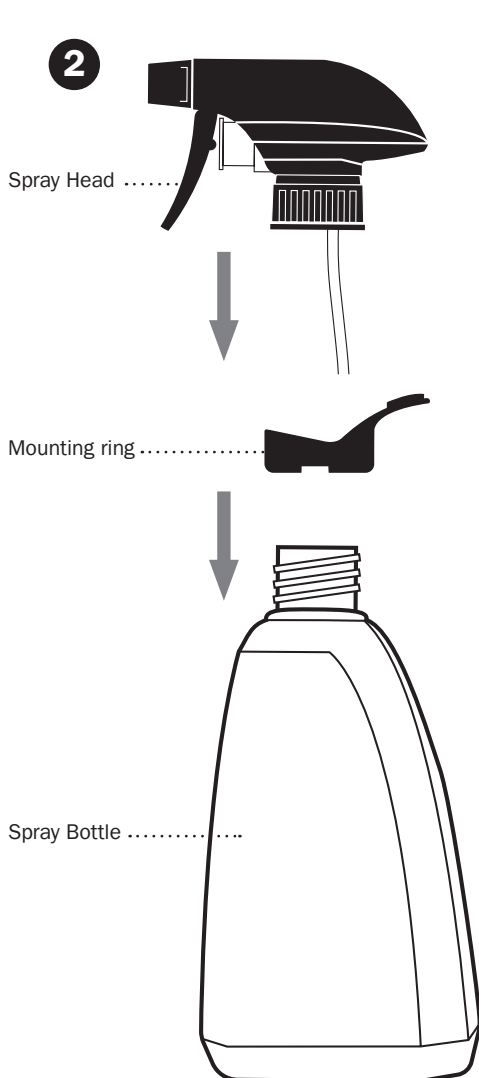

7. Pull the microfibre cover over the bracket of the wiping attachment and secure it with the Velcro fastener (Fig. 4).

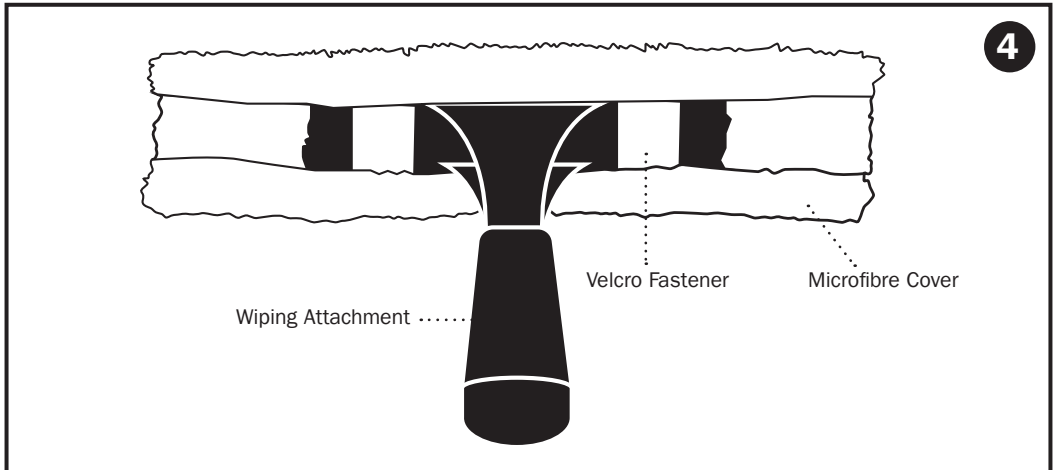

8. Spray the surfaces to be cleaned liberally.
9. Wipe over the surfaces, which have been sprayed with the microfibre cover, in order to clean them.
10. For heavily soiled surfaces, repeat the process again, if necessary. For very dirty surfaces, you should also rinse out or change the microfibre cover in between.

Vacuuming

1. Press the On/Off button. The battery indicator lights up red.
2. Guide the squeegee lip of the window cleaner slowly from top to bottom over the wet surface. Hold the device parallel with the surface to be squeegeed so the squeegee lip will be positioned at the correct angle & the water is sucked into the storage tank.
3. Apply the squeegee lip to the top again, once you have squeegeed a section dry.

Do not guide the squeegee lip sideways over the wet surface. The water cannot be vacuumed up this way and runs down the side of the squeegee lip. Always work from top to bottom.

4. If you are cleaning floor tiles in a horizontal position, you must hold the window cleaner vertically from time to time. In this position, the water in the window cleaner then flows into the water storage tank. A valve prevents it from flowing back. **If you do not do this, the water ends up in the fan. You will then hear a buzzing noise and water will leak out of the bottom of the device.**
5. Switch the window cleaner off once the surface is dry.
6. Remove any streaks or moisture residue with a dry cloth.

Emptying The Water Tank

1. Switch the window cleaner off.
2. Remove the water storage tank of the window cleaner by holding the recessed grips and pull the tank out of the device at an angle towards the front and down.
3. Turn the non-return valve counterclockwise and remove it (Fig. 5).
4. Empty out the dirty water.
5. Reinsert the non-return valve into the water tank and turn it clockwise, as far as it will go. Recesses and retaining lugs must be perfectly fitted to engage.
6. Reinsert the water storage tank into the window cleaner.

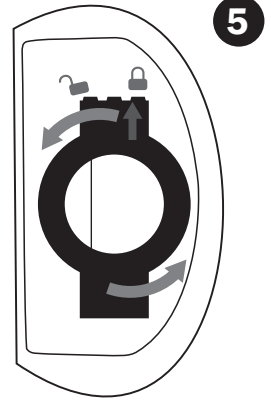

Cleaning The Spray Bottle

1. Remove the wiping attachment by pushing it slightly forwards and then pulling it upwards.
2. Open the spray bottle and empty it out.
3. Remove the microfibre cover.
4. Wipe all parts of the spray bottle with a damp cloth. Use a mild detergent, if necessary.

Washing The Microfibre Cover

The microfibre cover must be hand washed only & dried naturally.

Cleaning The Window Cleaner

1. Press the unlocking button and pull the squeegee attachment off of the device.
2. Clean the squeegee attachment with a slightly dampened cloth & mild detergent.
3. Remove the water storage tank by holding the recessed grips and pull the tank out of the device at an angle towards the front and down. Rinse with fresh water and then leave it to dry.
4. Clean the device housing from the outside with a slightly dampened cloth & mild detergent.
5. Allow all parts to dry prior to reassembling the device.
6. Store the window cleaner upright in a dry, frost-free place.
7. Store the squeegee attachment with the squeegee lip to prevent stress and pressure points.

Troubleshooting Guide

Problem	Solution
Device not running.	Ensure the battery is fully charged. Is the charging device still connected? Remove the charging cable.
Water is not being vacuumed up properly.	Guide the squeegee lip of the window cleaner slowly from top to bottom over the wet surface, not sideways. The device should be moved parallel to the work surface.
A buzzing noise can be heard and water is leaking out of the bottom of the device.	Hold the window cleaner vertically for a short time, so that the water in the device can run into the water storage tank.

Technical Support

If you require any technical support for your product within the warranty period, please contact us on **support@dmdcollective.co.uk** and provide the product name and supplier code (see Technical Specifications) along with the technical query and proof of purchase.

WEEE



The WEEE symbol  on this product means that this unit should be ethically dismantled or recycled to minimise environmental impact. Please check with your local authority for more information.

IMPORTANT: ADDITIONAL SAFETY INFORMATION

This device is **NOT** intended for use by persons (including children) with reduced physical, sensory or mental capabilities, or lack of experience and knowledge, unless they are supervised or have been given instruction concerning use of the device by a person responsible for their safety.

Technical Specifications

Product Name:	DMD Electric Window Cleaner
Supplier Code:	DMD134
Adapter Voltage:	Input: 220V~240V, Output: 5V DC
Adapter Frequency:	50/60Hz
Cleaner Battery:	3.7V, 2200mAh Li-Ion
Cleaner Power:	12W
Tank Capacity:	200ml
Material :	ABS & PP
Charging Time:	3.5hrs approx.
Operating Time:	35mins approx.



Ace Supply Co Ltd.,
Suite GA, Marsland House
Marsland Road, Sale M33 3AQ

For Product Support:
E: support@dmdcollective.co.uk
T: +44 (0)161 543 6400

EU Regd. Address: Ace Supply Co (Europe) Ltd.,
25 Herbert Place, Dublin 2, D02 A098
Republic of Ireland

www.dmdcollective.co.uk